

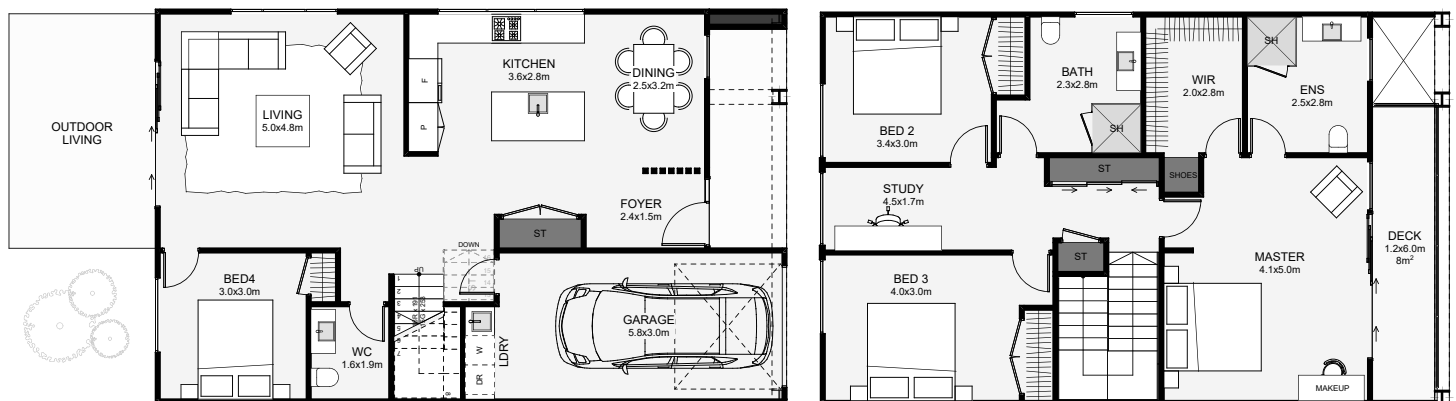

This four-bedroom townhouse has an industrial tone with its brick and steel frontage. Downstairs, the living is tucked away privately, there's a separate bedroom for guests and a laundry that's cleverly tucked under the stairs. Upstairs is three bedrooms, a study and two bathrooms. An expansive master with a large walk-in wardrobe and ensuite makes use of its position with its very own private balcony. This is a townhouse packed with luxuries, even the most discerning urban goers can enjoy!



Floor Area: 182m²

1 car 4 beds 2.5 bathrooms 1 lounge 12.9m 8.1m

Contact us

Ph: 0459 709 231

E: mark@aspiringhomes.com.au

www.aspiringhomes.com.au

Aspiring
HOMES